

Pressure sensors for precision measuring with internal diaphragm and stainless steel measuring cell

Accuracy 0.1 % according to IEC 61298-2

Standard output : **4 to 20 mA; 2-wire system**
 or 0 to 20 mA; 3-wire system
 or 0 to 10 VDC; 3-wire system



Special features

High overload protection
Highly resistant to shock and vibration
Good reproducibility

Applications

For all gaseous and liquid pressure media,
which do not attack the measuring system
and do not crystallize or react viscous.

Areas of use

Development and laboratory,
Plant and apparatus construction,
monitoring of measuring medium

Model	SD-36	SD-37
Accuracy	0.1 % from full scale value	
Connection thread	1/2" NPT	1/4" NPT
Ranges in psi	0...1.5, 2.5, 3.5, 5, 10, 15, 20, 35, 60, 100, 150, 200, 350, 500, 600 0...1,000, 1,500, 2,000, 3,500, 5,000, 6,000	
Overload limit	2-times full scale value	
Sensor element	piezoresistive stainless steel cell to 25 bar, from 40 bar thin film technology, welded	
Repeatability	< 0.03 % full scale value	
Stability per year	< 0.1 % full scale value in rated conditions	
Case	CrNi steel	
Wetted parts	CrNi steel, up to 40 bar with O-ring Viton (FKM)	
Electrical connection	Plug according to EN 175301-803 (DIN 43 650) / ISO 4401 with junction box	
Power supply	10 to 30 VDC (14 to 30 VDC for output 0 to 10 V)	
Power consumption	For 4 to 20 mA output: signal current, for vol bei Spannungsausgang 8 mA	
Permissible load	Current 2-wire: $R_{max} = ((UB-UB_{min}) / 0,02) \text{ Ohm}$, voltage: $R_{min} = 10 \text{ K Ohm}$	
Short-circuit protection	S + to U -	
Reverse polarity protection	U + to U -	
CE-conformity	Pressure Equipment Directive - 97/23/EG EMC-Directive to EN 61 326	
Operational life	> 50 million pressure cycles	
Temp.compens`n. range	32°F to 176°F (0 to 80 °C)	
Temp. influence	0.05 % / 10 K, zero point and span	
Response time	< 30 ms (within 10% to 90% of F. S.)	
Protection type	IP 65 to EN 60529 /IEC 529, option: IP 67 upon request.	
Temperatures	Medium: -4°F to 176°F (-20°C to 80°C), Ambient: -13°F to 176°F (-25°C to 80°C)	
Weight	0.44 lbs	

Dimensions and Design

Model SD-36

Model SD-37

Standard version, IP 65
Plug according to EN 175301-803 (DIN 43 650) / ISO 4401 with junction box

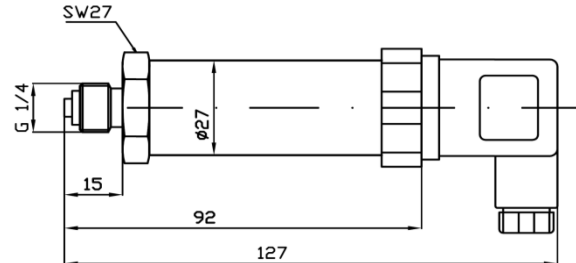
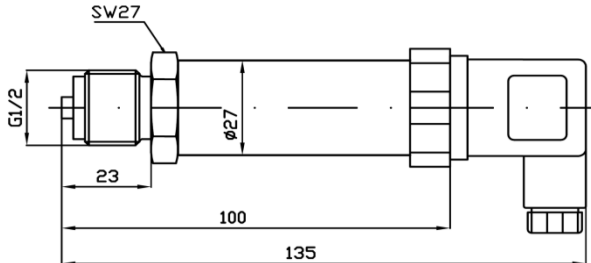

Two-wire system 4...20 mA

Three - wire system 0...20 mA and 0...5/10 V

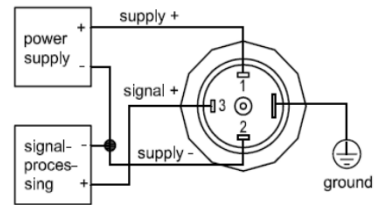
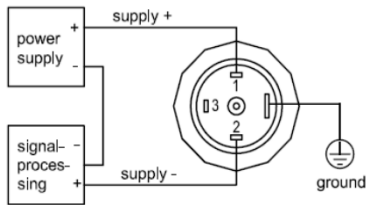

option, IP 67
Circular connector M 12 x 1, 4-pin

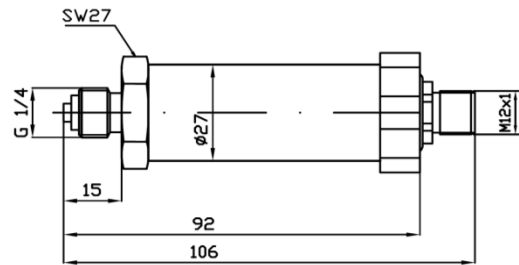
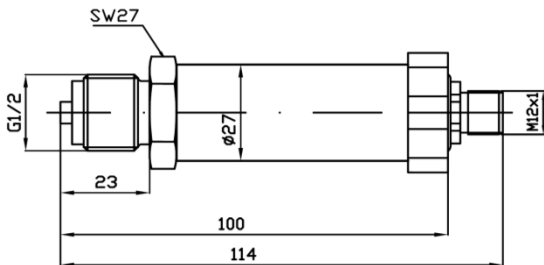

Two-wire system 4...20 mA

Three - wire system 0...20 mA and 0...5/10 V

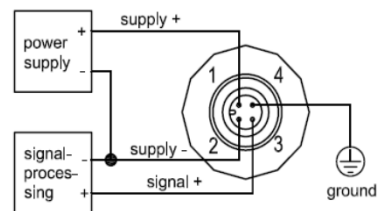
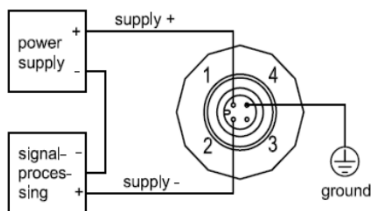

Dimensions and Design

Model SD-36

Model SD-37

option, IP 67 oder IP 68
cable outlet with 2 meters securely connected PVC-cable,

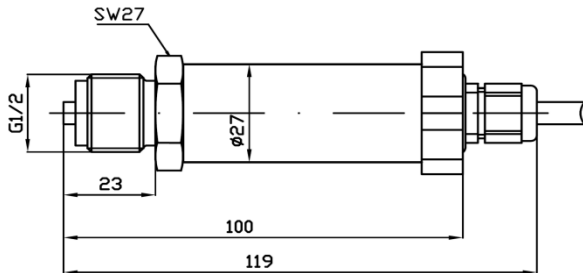

Two-wire system
4...20 mA

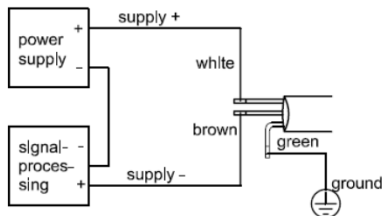

cable colours to DIN 47 100

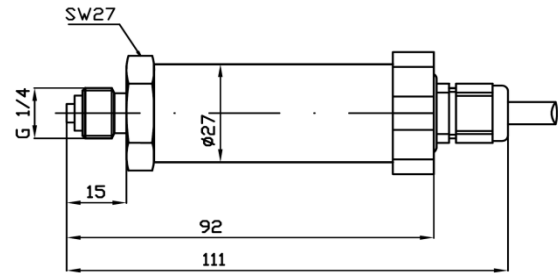

Three - wire system
0...20 mA and 0...5/10 V

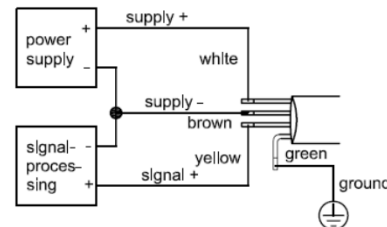

cable colours to DIN 47 100

option, IP 67
compact field housing

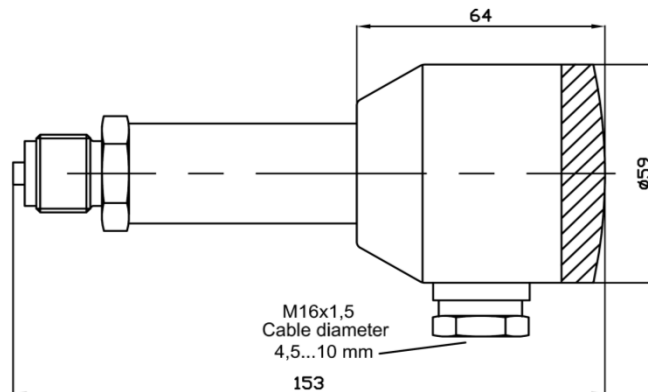

Exclusively distributed in North America by:



Phone: 877-866-8500
www.bristolinstruments.com
65 Sprague Street • Boston, MA 02136