



Data Sheet  
**Heavy Duty Pressure Sensors**  
**SD-30 / SD-32 Series**

*Distributed by*



[www. BristolInstruments.com](http://www.BristolInstruments.com)

Bristol Instruments  
65 Sprague Street  
Boston, MA 02136

Toll free  
877-866-8500

# Heavy Duty Industrial Pressure Sensors with internal diaphragm

Accuracy: 0.25 % and 0.5 %

Standard output 4...20 mA; 2-wire system  
 or 0...20 mA; 3-wire system  
 or 0...5 VDC; 3-wire system  
 or 0...10 VDC; 3-wire system

### Features

- High overload protection
- Corrosion resistant ,stainless steel design
- Highly resistant to shock and vibration
- Good reproducibility

### Applications

- Development and laboratory,
- Process engineering,
- Plant and apparatus construction,
- Hydraulics and pneumatics,



Model	SD-30	SD-32
Accuracy	0.5 % of full scale value	0.25 % of full scale value
Ranges in bar	0...0.1, ...0.25, ...0.4, ...0.6, 1, 1.6, 2.5, 4, 6, 10, 16, 25, 40, 60, 100, 160, 250, 400, 0...600, 1,000, 1,600, 2,500, 4,000	
Overload limit	-0.6 / 0, -1 / 0, -1 / +0.6, -1 / +1.5, -1 / +3, -1 / +5, -1 / +9, -1 / +15, -1 / +24	
Sensor element	to 16 bar - 2.0 x from 25 to 600 bar - 2.0 x over 600 bar - 1.5 x	
Repeability	from 0.1 to 16 bar piezoresistive, over 25 bar in Thin film	
Stability per year	< 0.05 % full scale value	
Case	< 0.2 % full scale value in rated conditions	
Wetted parts	CrNi steel	
Pressure connection	SW 27 CrNi steel	
Electrical connection	plug according to DIN 43650 with junction box	
Power supply	10...30 VDC (14...30 VDC for output 0...10 V)	
Power consumption	Output 4...20 mA: signal current	voltage output: 8 mA
Temp.comp.range	0...80 °C	
Temp. influence	0.2 % / 10 K, zero point and measuring element	
Response time	< 1 ms (within 10% to 90% of full scale value)	
Protection type	IP 65 to EN 60529 /IEC 529	
Temperatures	Medium: -30°C up to 100°C, Ambient: -20°C up to 80°C	
Weight	0.2 kg	

## Dimensions and Design

with internal diaphragm

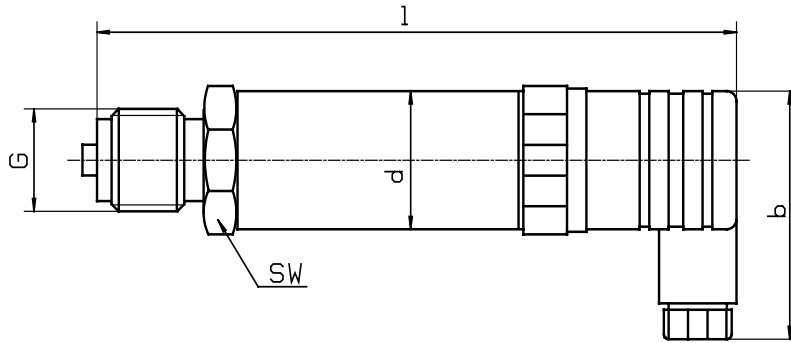

## Electrical connection

### Two-wire system

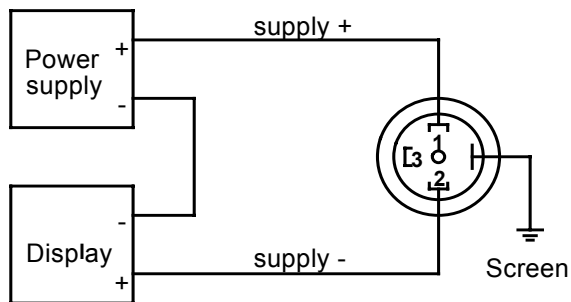

### Three - wire system

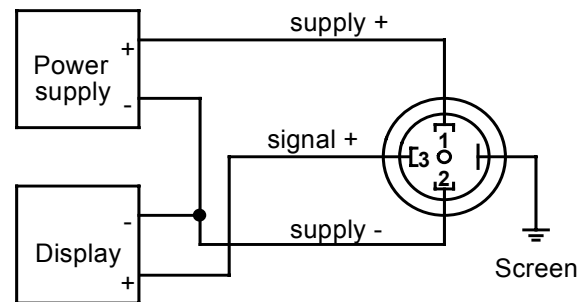

Dimensions in mm						
Model	b		d	l	SW	G
SD-30	48		27	133	27	G 1/2 B